

Trapac® Universal Single Safety Step



Installation

Determine the location of the steps which must be fitted on undamaged tiles with both nibs in good condition. The load bearing battens where the step hooks over must also not be defective. If the brackets are not fully resting on the lower tiling batten, an

additional batten must be fixed. Hook step over the batten and the tile within the trough/pan of the tile making sure that the underside of the hook is up against the top of the tile. Once the step has been secured to the batten, align and level the tread according to the pitch of the roof.

Klober's installation instructions should be followed closely when fitting this product.

Trapac® Universal Single Safety Steps are a universal, adjustable galvanised metal step that provides easy access on pitched roofs.

Product features & benefits

- Quick & easy to install
- Galvanised & powder coated
- Universal application suits clay & concrete interlocking tiles
- Anti-slip surface
- Lightweight
- Additional hand opening within the tread provides added safety for the roofer when walking up the roof
- Alignment of the tread area makes the step suitable for roof pitches from 20° to 50°
- Left/right brackets are interchangeable to allow them to fit within the trough/pan of the tile

Area of application

Suitable for:

- New build & refurbishment
- Clay & concrete interlocking tiles with a batten depth between 24mm - 40mm. The complete thickness of the tile and batten must not exceed 60mm
- Roof pitches between 20° & 50°

Material

Safety Step: galvanised flat steel DX51D-Z275 to DIN EN 10346:2009

Overcoating: galvanized and powder coated

Product code / Packaging

KS 9102 / 10 pieces

Colour codes

Terracotta	-9804	Galvanised	-0370
Dark brown	-9819	Black	-9905

Regulations

- CE-certified
- In accordance with DIN EN 516 class 1 and DIN 18160-5 and Ö Standard B 8207

TECHNICAL DATA

Dimensions	WxL: 250 x 130mm
Roof pitches	20° - 50° with 10 adjustment possibilities
Positioning / Corrugation	3-fach: 150mm 185mm 220mm
Batten depth	24 to 40 mm
Maximum thickness of Tile & Batten	max. 60 mm
Maximum Batten Spacing	≤ 370mm > 370mm with support batten
max. watercourse depth	50mm
Distance between steps (vertically)	< 40cm
Installation	installed in zig zag position along the vertical line
Weight	approx. 1.7kg/kit



Klober Ltd

Unit 6F · East Midlands Distribution Centre · Short Lane · Castle Donington · Derbyshire · DE74 2HA
Tel. +44 (0)1332 813 050 · Fax +44 (0)1332 814 033 · www.klober.co.uk · info@klober.co.uk

KLOBER

Trapac® Universal Single Safety Step

Installation instructions

Trapac® Single Step 25 (KS 9102)

Trapac® Einzeltritt 25 (KS 9102)

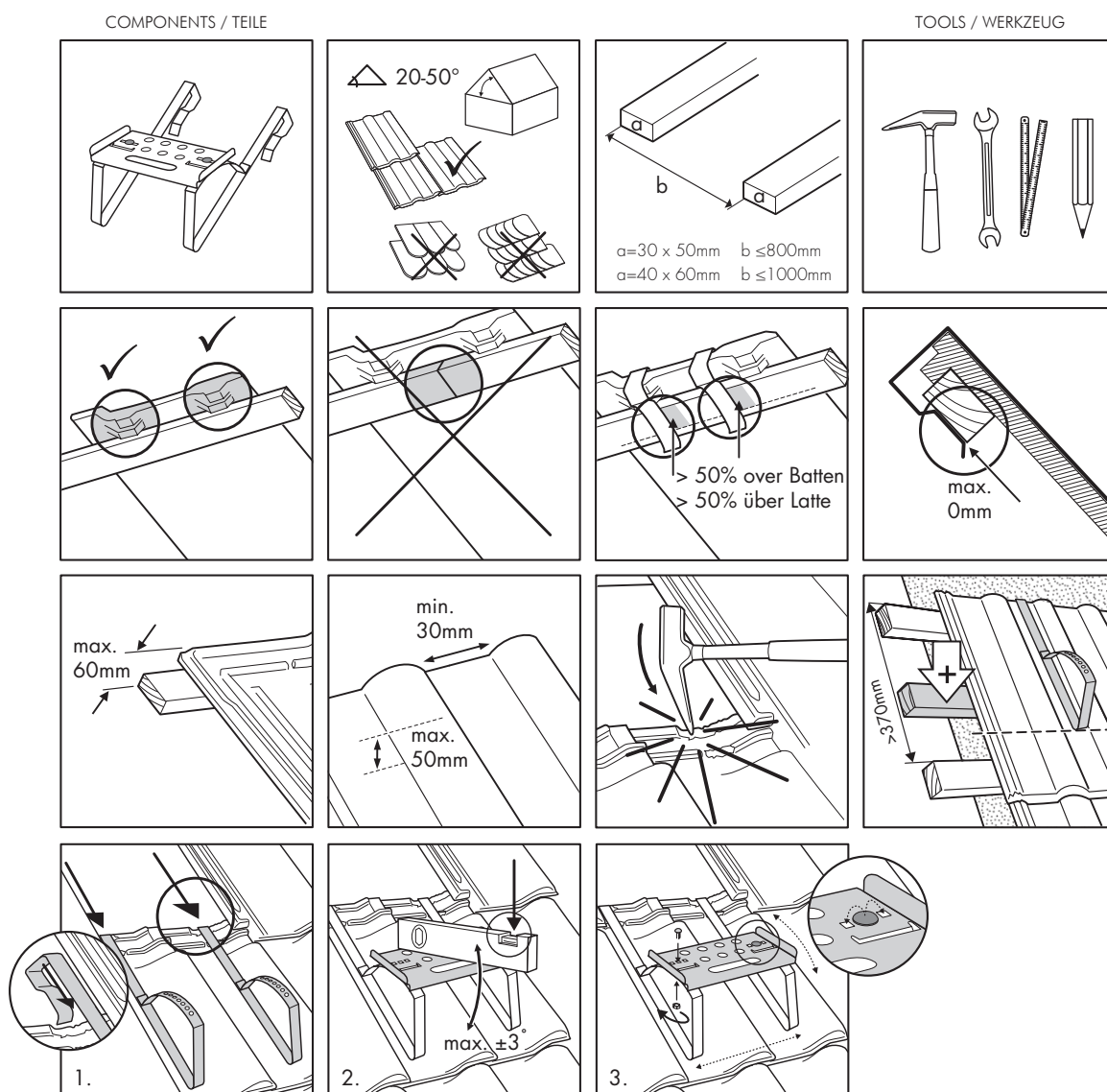

NOTE: Current versions of standards and safety regulations must be adhered to.

HINWEISE: Normen und Sicherheitsvorschriften in der jeweiligen neuesten Fassung sind einzuhalten.

REMARQUES: Respecter les normes et la réglementation sur la sécurité en vigueur.

OPMERKINGEN: Er dient aan de actuele normen en veiligheidsvoorschriften te worden voldaan.

INDICAZIONI: E' necessario osservare le norme e le prescrizioni di sicurezza nella loro edizione più aggiornata.

UWAGI: Należy przestrzegać krajowe aktualne normy, zalecenia i przepisy bezpieczeństwa.

UPOZORNENIE: Je nutné dodržat normy a bezpečnostné predpisy v príslušnom najnovšom znení.